



ADVOCATING FOR EQUITY IN EDUCATION & HEALTH CARE



Presented by

The California Endowment



Kaiser Permanente



California School-Based Health Alliance Statewide Conference

May 6, 2016 • Sacramento

Advocating for Equity in Education & Health Care Is Presented By
The California Endowment

#HEALTH4ALL
KIDS



Putting Health Care Where Kids Are

The **California School-Based Health Alliance** is the statewide nonprofit organization leading the movement to put health care where kids are—in school. Our mission is to improve the health and academic success of children and youth by advancing health services in schools. We are working toward a future when all students have access to the health services they need to be successful in school. **Visit us online at www.schoolhealthcenters.org.**

Become a member and help us make school-based health care an integral part of the educational and health care systems.

2015-2016 Members & Donors

Partners for Opportunity

All-In Strategies
Raymond Clayton ★
Shirley Liu Clayton
Dairy Council of California
Merry Grasska ★
PlushCare
Max & Diane Stites
Kimberly Uyeda

Advocates for Student Success

Serena Clayton ★
Mark Cooper ★
Cecilia Echeverria
Health Net of California ★
Jan Marquard-Tormey ✦
Joseph Pasquariello
Santa Rosa Community Health Centers
Tulare Community Health Clinic ★
Dexter Webster

Champions for Healthy Kids

Kristin Andersen ★
Naoto Chosa
Alison DeJung
East Bay Asian Youth Center ✦
Ken Geisick ★
Golden Valley Health Centers
James Morehouse Project ★
Pamela Kahn ★
Barbara Kronick
Los Angeles Trust for Children's Health ★
Michael Miller ★
Kathy Ryan

Organizations

Adventist Health
Alameda County Health Care Services Agency
Alameda Family Services ★
Alexander Valley Healthcare
American Medical Overseas Relief
Asian Health Services
Bakersfield City School District
Barton Health
Bay Area Community Resources
California Association of Rural Health Clinics
California Center for Civic Participation
California Pan-Ethnic Health Network ★
California Partnership to End Domestic Violence
Camarena Health
CASSY

Castle Family Health Centers, Inc.
Child and Family Guidance Center
Chino Valley Unified School District
City of Berkeley
Compassion for Teen Life
Contra Costa County Health Services ★
Culver City Unified School District
Daly City Youth Health Center
Earlmarl Elementary School District
East Bay Agency for Children
East Valley Community Health Center, Inc. ★
Elica Health Centers
Emery Unified School District
Family Health Care Nursing, UCSF
Family Health Centers of San Diego ★
Foothill Community Health Center
Fred Finch Youth Center
Fresno County Office of Education ★
Healthy Connections
Kings Canyon Unified ✦
Institute for Health Policy Studies, UCSF
Irvine Unified School District
LA's Promise
La Clínica de la Raza ★
La Maestra Community Health Centers
LifeLong Medical Care ✦
Livingston Community Health
Los Angeles Unified School District
Lucile Packard Fdn. for Children's Health
Madera Unified School District
Maxim Healthcare Services
Merced Union High School District
Native American Health Center ✦
Natomas Unified School District
Northeast Valley Health Corporation ★
Novato Youth Center ★
Operation Samahan ★
Orland Joint Unified School District
Pacific Health Consulting Group ★
Pajaro Valley USD Healthy Start
Parlier Unified School District
Petaluma Health Center, Inc.
Potter Valley Youth & Community Center
The Primary School
ProYouth
Redwoods Rural Health Centers, Inc.
Ridgecrest Regional Hospital
Sacramento City Unified School District ★
Salud Para La Gente ✦
San Diego Unified School District
San Francisco USD Wellness Initiative
Sandy Segal Youth Health Center

Santa Barbara Neighborhood Clinics
School Health Clinics of Santa Clara County
Social Advocates for Youth
Tahoe Forest Health Systems
T.H.E. Clinic, Inc. ★
Tiburcio Vázquez Health Center, Inc. ★
Tri-City Health Center
Tulare County Office of Education
UCSF Benioff Children's Hospital, Oakland
UMMA Community Clinic ★
United Health Centers of San Joaquin Valley
Valley Community Healthcare ★
Valley Health Team ★
Venice Family Clinic
West Contra Costa Unified School District
Western University of Health Sciences
YMCA of the East Bay ★

Individuals

Elizabeth Adame
Pamela Avila
Sarah Brown
Elisabeth Chicoine
Brandi Dobbs
Joan Edelstein
Susan Elizabeth
Carol Ferre
Martin Gonzalez ★
Kathy Hahn
Steven Holtzman
Debra Johnston
Jenny Kattlove
Victoria Keeton
Sonia Khan
Maria Lemus
Elaine Littleton
Teresa McFarland
Ryan McQuaid
Jacob Moody
Michele Rigsby Pauley
Bertrand Perdomo-Ucles
Susan Pintar
Jeanette Providence
Rachel Robitz
Joanie Rothstein
Michael Shannon
Deanna Staggs ✦
Katharina Streng
Ahna Suleiman
Lori Urbanec
Heather West
Dianne White
Marcia M. Zorrilla

✦ Consecutive 6-yr Member ★ Consecutive 7+ yrs Member

Board of Directors

Staff

President

Barbara Kronick, LCSW

Director, Student Support and Health Services,
Sacramento City Unified School District (*Retired*)

Vice President/Secretary

Ken Geisick, EdD

Superintendent, Orland Unified School District

Treasurer

Dexter Webster, MBA

Chief Operations Officer, POWER BOX Media Group

Board Members

Mark Cooper, DDS

St. Helena-Clearlake Hospital

Cecilia Echeverria, MPP, MPH

Director, Safety Net Partnerships, Kaiser Permanente

Michael Miller

President, Brown Miller Communications Inc.

Jan Marquard, MPH

Director of Planning and Advocacy for School Health Services,
Northeast Valley Health Corporation

Todd Gower

Senior Manager, Ernst and Young

Michael Lujan

Co-founder of Limelight Health

Kimball Wilkins

Senior Director of Market Strategy and Insights, Blue Shield of California

Bertrand Perdomo-Ucles

Teacher, Teach for America

Michele Rigsby Pauley, RN, CPNP

Director of Clinical Services, COACH For Kids,
Cedars-Sinai Medical Center

Kimberly Uyeda, MD

Director of Student Medical Services,
Los Angeles Unified School District

Heather West

Senior Public Programs Administrator, Health Net of California

Executive Director

Serena Clayton, PhD

Program Manager, Adolescent Health

Molly Baldrige, MPH, CHES

Communications Program Assistant

Lourdes Bernal

Associate Director, Development

Shella Brenner

Senior Policy Analyst

Lisa Eisenberg, MPP, MSW

Project Director, Mental Health

Stephanie Guinasso, PhD

Program Manager, Central Valley

Salina Mendoza, MS

Communications Director

Marcel Reynolds

Program Assistant

Israel Rodriguez Rubio

Director of Operations

Maria Salzano

Senior Project Director

Janine Saunders, MPH

Administrative Program Assistant

Elaine Segura

Associate Director, Programs

Juan Taizan, MPA



Schedule At A Glance

► 8:00 – 9:00 AM

EXHIBITS, REGISTRATION, BREAKFAST

LOBBY LEVEL & GRAND NAVE FOYER

- Register and sign up for continuing education credits.
- Visit the exhibitors and make sure to get your raffle card stamped by each exhibitor. Turn in your completed raffle card to the California School-Based Health Alliance's exhibit table **by 3:00 pm** to be entered into a drawing to **win an iPad mini**. The drawing will be held during the closing session. You must be present to win.

► 9:00 – 10:15 AM

OPENING PLENARY & AWARDS

GRAND NAVE BALLROOM

- Join us for a warm welcome from the California School-Based Health Alliance.
- Honor the contributions of school health champions in California.

► 10:15 – 10:45 AM

EXHIBITS & BREAK

LOBBY LEVEL & GRAND NAVE FOYER

- Visit the exhibits and poster presentations (*descriptions on p. 4*). Make sure to get your raffle card stamped by each exhibitor so you can be entered into a drawing to **win an iPad mini**. The drawing will be held during the closing session. You must be present to win.

► 10:45 AM – 12:00 PM

WORKSHOP 1

- Choose from one of eight workshops (*full descriptions on p. 7*).

► 12:00 – 1:15 PM

LUNCH, AWARDS, EXHIBITS

GRAND NAVE BALLROOM

- Join us in honoring a school health champion who is advancing children's health in California.
- Visit the exhibitors and make sure to get your raffle card stamped by each exhibitor. Turn in your completed raffle card to the California School-Based Health Alliance's exhibit table **by 3:00 pm** to be entered into a drawing to **win an iPad mini**. The drawing will be held during the closing session. You must be present to win.
- View the poster presentations (*descriptions on p. 4*).

► 1:15 – 2:30 PM

WORKSHOP 2

- Choose from one of seven workshops (*full descriptions on p. 8*).

► 2:30 – 3:00 PM

EXHIBITS & BREAK

LOBBY LEVEL & GRAND NAVE FOYER

- Visit the exhibits and poster presentations (*descriptions on p. 4*). Turn your stamped raffle card into the California School-Based Health Alliance exhibit table **by 3:00 pm** to be entered into a drawing to **win an iPad mini**. The drawing will be held during the closing session. You must be present to win.

► 3:00 – 4:15 PM

WORKSHOP 3

- Choose from one of seven workshops (*full descriptions on p. 9*).

► 4:20 – 5:00 PM

CLOSING SESSION

GRAND NAVE BALLROOM

- Get recharged by a performance by student health advocates with The Bigger Picture.
- Don't miss the raffle drawing for the **iPad mini**. You must be present to win.

The California School-Based Health Alliance Board Is Proud to Present

The 2016 School Health Awards

Every year, the California School-Based Health Alliance Board of Directors recognizes School Health Champions who work tirelessly to bring health care to kids at school. We applaud all of the practitioners and advocates who are helping ensure that every child has the chance to be healthy and successful. For 2016, we are proud to honor two champions for their outstanding contributions advancing school health through policy and school community leadership.

This year we are also awarding a school-based health center the Red Apple Award for exceptional work in providing students with unique and age-appropriate care.

Legislative Champion: Senator Richard Pan



As the representative of California's 6th Senate District, the Honorable Dr. Richard Pan is a pediatrician, former UC Davis educator, and advocate for health and education. In 2015, he authored landmark legislation to abolish non-medical exemptions to legally required vaccines for public school students and improved community immunity across California. Dr. Pan has been a long-term advocate for school-based health services and has been a resource when thinking of innovative ways to fund school health services. The son of immigrants, Dr. Pan attended public schools and understands what California's children need to be healthy and ready to learn.

School Community Leader: Michelle Oppen



Michelle Oppen has served as the Wellness Coordinator for the Oakland Unified School District (OUSD) since 2009. During that time, she has developed a nationally-recognized model for providing health and wellness services in school. Michelle has established a network of school-based wellness champions, who she mentors in providing wellness services tailored to the needs of their school community. She also collaborates with other OUSD departments that are critical to the health of the whole child, including school nurses, nutrition services, social and emotional learning, and others. Michelle is creating healthier schools for Oakland's 37,000 students.

Red Apple Award: San Fernando Teen Health Center



The San Fernando High School Teen Health Center (SFHS THC) is the winner of the inaugural Red Apple Award for School-Based Health Center Excellence. This award lifts up the exemplary practices of a school-based health center in California that is a model for delivering health care to students that is convenient, accessible, age-appropriate, and effective. The SFHS THC was chosen because of its innovative use of social media to connect students to care and its extraordinary partnership with teachers. In just six months, the clinic tripled its Instagram followers while delivering teen-friendly health education messages and building relationships with students. The SFHS THC is truly a model of SBHC excellence.

☐ **Reducing Environmental Asthma Triggers for Kids at Schools**

FALOR

Asthma is the most common cause of illness among children in the U.S. and is the leading cause of school absences. Learn how school-based health centers can help kids reduce exposure to environmental asthma triggers.

SPEAKERS: *Anne Kelsey Lamb*, MPH, Director, Regional Asthma Management and Prevention (RAMP); *Nova Wilson*, Program Manager/Health Educator, Native American Health Center; *Eric Medina*, Quality Improvement Coordinator, Altura Centers for Health; *William Retz*, Community HealthCorps Member, UMMA Community Clinic

☐ **Opportunities for School-Based Health in Health Care Reform**

BONDI

Learn about efforts to engage the health care system and sustain SBHC services beyond primary care visits. Hear about ways that SBHCs are benefiting health plans by managing chronic diseases, improving population health, and addressing social determinants of health.

SPEAKERS: *Serena Clayton*, PhD, Executive Director; *Lisa Eisenberg*, MPP, MSW, Senior Policy Analyst; *Salina Mendoza*, MS, Program Manager – California School-Based Health Alliance

☐ **Group Obesity Visits for Students of Color in SBHC Settings**

HENDRICKS

Learn about a model for group health education and medical visits that is being implemented at three urban school sites. Changes in physical outcomes, self-efficacy, and health behaviors will be discussed.

SPEAKERS: *Naomi Schapiro*, RN, PhD, CPNP, Clinical Professor, UCSF, Family Health Care Nursing; *Atziri Rodriguez*, Clinic Manager, Native American Health Center; *Mizan Alkebulah-Abakah*, MPH, Clinic Manager, La Clínica de la Raza

☐ **Connecting Schools & Health: Addressing Disparities to Improve Academic Success**

CARR

Learn how a large urban high school is implementing a schoolwide assessment to address the most prevalent health disparities facing students. See how health programs that meet the needs of students are contributing to improved academic outcomes.

SPEAKERS: *Bonnie Trinclisti*, MS, RN, FNP, Director of Adolescent Health Services; *Louise Torrez*, MA, Medical Assistant; *Jessica Vu*, ASW, Youth Clinical Social Worker – Native American Health Center

☐ **Listening to Heal: Building Beloved Community**

KAMILOS

This interactive session will present the findings and actions taken from a school-based and community-engaged inquiry process focused on the experiences of trauma, violence, coping, and healing for young people of color in Richmond.

SPEAKERS: *Kanwarpal Dhaliwal*, MPH, Director of Community Health and Integrative Practice; *Brian Villa*, Lead Community Health Coordinator – RYSE Center

☐ **SBHCs as a Crucial Stepping Stone on the Health Career Pathway**

BAKER

One school-based health center is expanding its role beyond clinic walls to prepare students to enter health careers. Explore a unique partnership and discuss the school district's role in facilitating student professional development.

SPEAKERS: *Ignacio Ferrey*, MPH, MA, School Health Career Pipeline Coordinator, Center for Healthy Schools and Communities, Alameda County Health Care Services Agency; *Jelissa Parham*, MPH, Program Manager, Native American Health Center; *Antoinette Silva*, MPH, Clinic Supervisor, La Clínica de la Raza

☐ **Latest Trends in Expanding Access to Reproductive Health Care for Teens**

BEAVIS

Review best practices for providing quality sexual health care and discuss how school-based health providers can help students access services confidentially. Learn about screening, testing, treatment, and latest trends.

SPEAKERS: *Erica Neuman*, MS, Trainer & Project Director; *Sylvia Castillo*, Manager of Public Policy & Community Engagement – California Family Health Council

☐ **Comprehensive School-Based Mental Health: A District's Model for Prevention & Intervention**

COMPAGNO

Hear about a tiered prevention and intervention model for comprehensive school-based mental health services. See how a multi-disciplinary team can meet the needs of students and families, promote mental wellness, and addressing adolescent substance use.

SPEAKERS: *Melissa Hurd*, LEP, CWA, Coordinator of Mental Health & Outreach Services; *Joy Cleary*, LCSW, School Social Worker; *Michelle Lepak*, Ed.S., NCSP, Behavior Specialist – Newport-Mesa Unified School District

☐ ***School-Based Health Centers Kick Butts!***

FALOR

Find out how school-based health centers are training young people to lead tobacco prevention efforts. Gain tools to conduct a schoolwide tobacco needs assessment and resources to plan Kick Butts Day, a schoolwide tobacco prevention and advocacy day.

SPEAKERS: *Deanna Staggs*, Clinic Director, Edison School-Based Health Center, Delta Health Care; *Reginald Figgs*, Community Schools Coordinator, Greenwood Academy, YMCA of the East Bay

☐ ***The End of the Free Care Rule... What Now?***

BAKER

Explore what the reversal of the “free care rule” policy, which opens new opportunities for Local Education Agencies to draw down Medicaid dollars, means for how schools participate in the greater health system delivery transformation.

SPEAKER: *Erynne Jones*, MPH, Medicaid Policy Consultant, Harbage Consulting

☐ ***Engaging Black Youth in Radical Healing: Social – Emotional Interventions at SBHCs***

CARR

Learn strengths-based strategies that schools and school-based health centers can use to build resiliency and self-efficacy in Black youth. Explore culturally-supportive, youth-friendly operations from outreach and recruitment to staff professional development and school integration.

SPEAKERS: *Mizan Alkebulan-Abakah*, MPH, Clinic Supervisor, La Clínica; *Sizwe Andrews-Abakah*, Co-Founder, Spearitwurx

☐ ***We Are Reducing Oral Health Disparities!***

KAMILOS

Learn about a sustainable school-based oral health model that includes parents, teachers, students, nurses and multiple invested partners and is getting national attention by addressing disparities in oral health through a social justice lens.

SPEAKERS: *Maryjane Puffer*, BSN, MPA, Executive Director, The Los Angeles Trust for Children's Health; *Frances Walsh*, Oral Health Program Manager, The Los Angeles Trust for Children's Health; *Rebecca Dudovitz*, MD, MSHS, Assistant Professor, UCLA, School of Medicine, Department of Pediatrics

☐ ***Building School-Based Support of Unaccompanied Immigrant Youth***

COMPAGNO

The growing crisis of children immigrating without their parents or an adult guardian has profoundly impacted schools and school-based health centers. Learn about one county's coordinated response and emerging best practices for supporting these young people.

SPEAKERS: *Jasmine Gonzalez*, MA, MFTI, PPSC – Senior Clinical Case Manager, Center for Healthy Schools and Communities, Alameda County Health Care Services Agency; *Naomi Schapiro*, RN, PhD, CPNP, Clinical Professor, UCSF, Family Health Care Nursing ; *Juan Raul Gutierrez*, MD, MPH, Lead Physician, La Clínica de la Raza

☐ ***Brave New World: Youth + Tech + Health***

HENDRICKS

Interested in bringing technology into your adolescent health program but not sure where to begin? Find out about emerging, startling, and sometimes simple technologies that can reach young people where they are. No tech savvy required to attend!

SPEAKER: *Laiah Idelson*, Program Officer, youth + tech + health

☐ ***Parents & Schools Partnering to Improve Student Mental Health***

BEAVIS

Learn about programs at schools for student mental health education and awareness. Discuss how schools can partner with parents to create a mental health support system for students, and hear about ways to reduce stigma and empower youth as mental health advocates.

SPEAKER: *Beth Wolf*, Director of Programs, National Alliance on Mental Illness – California

☐ ***Increasing Clinic Utilization Through Youth Engagement***

BONDI

Learn sustainable best practices on how to effectively engage young people in the programs and services your SBHC offers with the goals of increasing clinic utilization and building strong relationships with your school campuses.

SPEAKERS: *Molly Baldridge*, MPH, Program Manager, Adolescent Health, California School-Based Health Alliance; *Atziri Rodriguez*, Clinic Manager, Native American Health Center; *Marcia Zorrilla*, DrPH, Project Coordinator/Health Educator, San Francisco Department of Public Health; *Stephan Salazar*, Manager of Adolescent Education, Valley Community Healthcare

☐ ***Nutrition Education Tools for Schools & SBHCs***

BEAVIS

Learn about exciting new nutrition education tools and resources for schools and school-based health centers. Participants will also discuss the latest dietary guidelines and find out about research regarding the connection between good health and academics.

SPEAKER: *Ashley Rosales*, RDN, Manager of Policy and Opinion Leader Relations, The Dairy Council of California

☐ ***The California Healthy Youth Act: Understanding the New Sex Education Law***

COMPAGNO

Find out what schools need to do to implement the new sex education law and how it will benefit students. Hear about opportunities for school health providers and the role of youth advocacy in moving this law forward.

SPEAKER: *Phyllida Burlingame*, Reproductive Justice Policy Director, ACLU of Northern California

☐ ***Working With LGBTQQIA Adolescents***

FALOR

Join us to learn more about a new toolkit designed for providers working with lesbian, gay, bisexual, transgender, queer/questioning, intersexed, and asexual/ally adolescents. Participants will leave this workshop with new resources to use when providing clinical care.

SPEAKER: *Sarah Rodriguez'G*, MS, Coordinator/Director, Adolescent Health Working Group

☐ ***Healthy Students Make Good Learners: Connecting Kids to Coverage & Care***

HENDRICKS

See how schools can connect children, families, and employees to health coverage and care. Learn about policy changes that impact children's health coverage and resources that you can use to connect kids to care.

SPEAKERS: *Kristelle Jose*, Campaign Program Associate, The Children's Partnership; *Maria Romero-Mora*, Program Coordinator, California Coverage & Health Initiative; *Teri Burns*, Senior Director, Policy & Programs, California School Boards Association

☐ ***Creating Trauma-Informed Schools***

CARR

Get a framework for educators, principals, and other school staff whose work involves students who have been exposed to childhood trauma. Learn about trauma-informed practices, biological and behavioral consequences of trauma, and staff burnout prevention.

SPEAKERS: *Lara Kain*, Senior Director; *Erin Browder*, Transformation Facilitator – Los Angeles Education Partnership

☐ ***Integrated, Accessible, and Sustainable Behavioral Health Services***

BONDI

Learn about a multidisciplinary clinical behavioral health model, strategies for effective integration, and methods for ensuring financial sustainability. Leave with a model for providing trauma-informed, integrated, and sustainable behavioral health services.

SPEAKERS: *Karen Gersten-Rothenberg*, FNP, Lead Nurse Practitioner; *Ruth Campbell*, LCSW, SBHC Behavioral Health Supervisor; *Gabriela de la Torre*, MCRP, MA, Planner – La Clinica de La Raza

☐ ***Supporting Students to Lead a Healthy Relationship Revolution***

BAKER

Learn about an innovative partnership between a county, two high schools, and a women's shelter that is preventing adolescent relationship abuse. Hear how to develop youth leadership skills and coordinate a sustainable collaboration between domestic violence and healthcare.

SPEAKERS: *Alison Chopel*, DrPH, MPH, Director; *Robert Lee*, MAEd, Program Manager; *Ana Andrade*, MA, Central Valley Program Manager; High School Youth Leaders – California Adolescent Health Collaborative

POSTER PRESENTATIONS

See best practices from school health programs across the state and learn about the latest research in the school health field. Poster presentations are on display in the Grand Nave Ballroom until 3:00 PM.

Evaluating Teen Pregnancy Prevention Curriculum

Learn about an evidence-based curriculum, “Reducing the Risk” (RTR) program that was implemented in Tulare to address teen pregnancy and STD prevention.

Presenters: *Cindy Ballesteros*, BS, Student; *Marcel Garcia*, MA, Research Analyst – Central Valley Health Policy Institute

Transforming Hollywood High Into a Wellness Campus

Find out about an innovative partnership between Hollywood High School, The Los Angeles Trust for Children’s Health, and Kaiser Permanente to reduce obesity and support healthier lifestyles for students, staff, and families.

Presenters: *Deborah Ebrahemi*, MSW, HEAL Program Manager; *Christian Beauvoir*, Student Engagement Program Associate – The Los Angeles Trust for Children’s Health

California Health Care Services in Schools at a Crossroads

Learn about the challenges and opportunities associated with school-based health care in California and how other states have overcome similar challenges.

Presenters: *Nadejda Marques*, PhD, Research Coordinator, School Health Services Project; *Eunice Rodriguez*, DrPH, Associate Professor (Teaching) – Stanford University

Population-Level Screenings & SBHCs

Interested in schoolwide screenings? Learn about a school-based health center (SBHC) screening toolkit, explaining the details of population-level screenings.

Presenters: *Naomi Schapiro*, RN, PhD, CPNP, Clinical Professor & PNP, Department of Family Health Care Nursing, UCSF; *Joanna Bauer*, BA, MPH, Clinic Manager, La Clínica de la Raza; *Victoria Keeton*, RN, MS, CPNP, CNS, Pediatric Nurse Practitioner & Associate Clinical Professor, La Clínica de la Raza & UCSF

Shoo the Flu Out of Oakland

Join us to learn about Shoo the Flu, a public-private partnership committed to improving health by decreasing flu in Oakland by increasing vaccination rates.

Presenters: *Hannah Warren*, BA, Vaccine Clinic Liaison, Oakland Unified School District; *Aleta Rattanasith*, BA, Administrative Specialist, Shoo the Flu

Integrating Comprehensive Oral Health Services into Primary Care in SBHCs

The Maternal and Child Health Bureau funded 12 projects to integrate comprehensive oral health services into primary care in school-based health centers (SBHCs). See the lessons learned from these projects.

Presenters: *Jennifer Pilapil*, BA, Operations Manager, Center for Oral Health; *Lynn Van Pelt*, DMD, Senior Program Analyst, Maternal and Child Health Bureau, Health Resources and Services Administration; *Beth Lowe*, RDH, MPH, Health Education Specialist, National Maternal and Child Oral Health Resource Center, Georgetown University

Family Planning Health Worker (FPHW) Certification Training

Providing reproductive health services? Learn about an innovative training and curriculum to prepare community members to serve as family planning health workers.

Presenter: *Erica Neuman*, MS, Trainer & Project Director, Learning Management, California Family Health Council

Local School Wellness Policy Collaborative: An Innovative Partnership

Learn how a collaborative of governmental agencies, nonprofit organizations, professional associations and schools are collaborating to help schools implement strong wellness policies.

Presenter: *Jan Lewis*, MA, RD, Action for Healthy Kids

closing performance

The Bigger Picture is a collaboration between the Center for Vulnerable Populations and Youth Speaks to end Type 2 diabetes in young people. The Bigger Picture empowers youth to raise their voices to change the conversation about Type 2 diabetes. The campaign has educated over 2,400 public Bay Area high school students, 40 youth poet mentors, and over 800 stakeholders about the social factors that affect the rising Type 2 diabetes crisis.





California
Health Care
Foundation

Health Care That Works
for All Californians

www.chcf.org



Teachers + Students + Families =



62,133

contacts made through student-led
health awareness campaigns

Schools + Parents + Students +
Community Dentists =



5,164

students screened and now with
access to oral health care

Joint-Use Funds +
14 Wellness Centers =



155,000

patient visits to date

HEALTH EQUITY



The L.A.
Trust

STUDENT HEALTH = STUDENT SUCCESS

*Committed to improving
health outcomes at school and
reducing health disparities*



**SIERRA HEALTH
FOUNDATION**

Molina proudly supports **the
California School-Based
Health Alliance.**

Thank you for helping so many students
receive health care in school.

MolinaHealthcare.com



3835257CORP0316



Benny Fit
Health Net



Congratulations
California School Health Centers
Thanks for making a difference!



Health Net is a registered service mark of Health Net, Inc.
© 2013 Health Net Community Solutions, Inc. All rights reserved.

Find a school-based health center near you at
www.californiahealthplus.com



**California
Primary Care
ASSOCIATION**

Thank you to our sponsors & exhibitors

PRESENTING SPONSORS



GOLD SPONSOR



BRONZE SPONSORS



Preferred Exhibitor

Learning ZoneXpress

— Exhibitors —

ALL IN Campaign
Allied Powers LLC
Blue Shield of California
California Department of Public Health
California Family Health Council
California Health Facilities Financing Authority
Canela Software
Delta Dental
ETR
Lucile Packard Foundation for Children's Health
Sqord
Thomson Screening
Universal Specialty Vehicles, Inc.
U.S. Food and Drug Administration (FDA)



We believe in a healthy future.

At Kaiser Permanente, we believe that everyone deserves access to high-quality care and healthy communities that help them thrive. That's why we proudly partner with organizations like California School-Based Health Alliance to help support a culture of wellness in schools. Together, we make a difference in the lives of students and their families.

To learn more visit kp.org/communitybenefit/ncal.



**KAISER
PERMANENTE®**

Conference Schedule

FRIDAY, MAY 6

8:00 - 9:00 AM	Registration/Breakfast/Exhibits [Glide's & Grand Nave Foyer]
9:00 - 10:15 AM	Opening Plenary Session [Grand Nave Ballroom]
10:15 - 10:45 AM	Exhibits/Poster Presentations [Glide's & Grand Nave Foyer]
10:45 AM - 12:00 PM	Workshop 1
12:00 PM - 1:15 PM	Awards Luncheon & Exhibits [Grand Nave Ballroom]
1:15 - 2:30 PM	Workshop 2
2:30 - 3:00 PM	Exhibits/Poster Presentations [Glide's & Grand Nave Foyer]
3:00 - 4:15 PM	Workshop 3
4:20 - 5:00 PM	Closing Session & Raffle Drawing [Magnolia Ballroom] <i>Featuring The Bigger Picture</i>

Sheraton Grand Sacramento Hotel

Lower Level

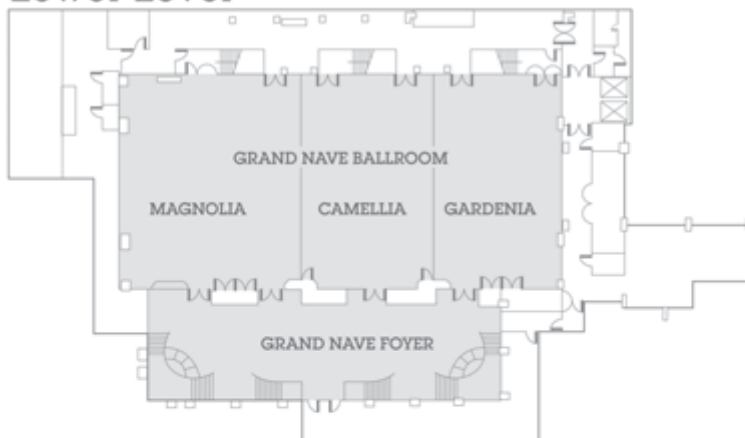

**Sheraton Grand
Sacramento**
HOTEL

Level 2



Level 3

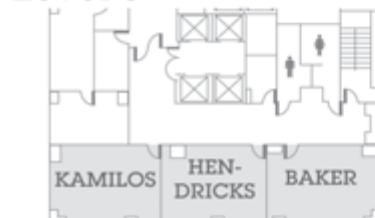

Lobby Level

Public Market Bar
Glide's Event Space

Level 4

Sheraton Fitness
Swimming Pool
Executive & Sales-Catering Office