



Connect the Community to Needed Resources

COMMUNITY PARTNERS

Connect IE is a **FREE one-stop interactive website** for partners and the public in the Inland Empire. It makes it easy for local organizations to put people in touch with resources in their community.

How Connect IE works: Community-based organizations like yours can streamline the way your team operates. Visit **www.ConnectIE.org** from your laptop, desktop or smartphone and start searching! With *Connect IE*, you can find:

- Food
- Transportation
- Housing Services
- Job training
- Other low-cost or free programs

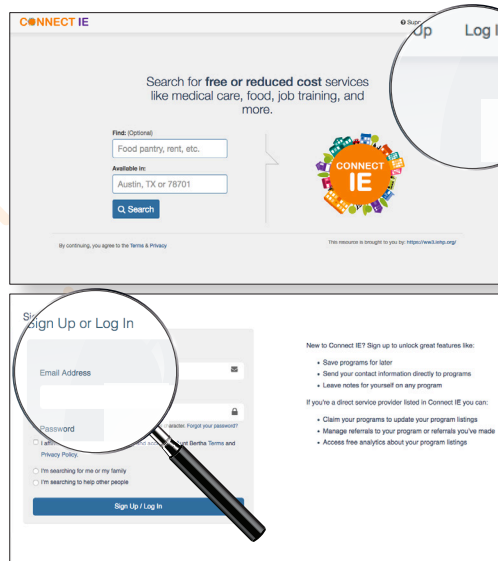

To log in, see the *Provider Training Guide*.

Benefits of Connect IE: It provides instant access to programs located in every zip code in the Inland Empire. *Connect IE* reports how many people are using your program. Plus, it can track the referrals you make.

Why use Connect IE? You can do your part to improve the health of your community. When you link people to social services and resources they need, their health could improve. This helps:

- Reduce hospital readmission rates and costs
- Cut the number of days that children miss school
- Reduce drop-out rates among students

To learn more or
apply for a program on behalf of your client,
visit www.ConnectIE.org

Sources: <https://www.cdc.gov/nchstp/socialdeterminants/definitions.html>
<http://www.who.int/en/news-room/fact-sheets/detail/mental-health-strengthening-our-response>